



Type VUS/INC check valves

- Ball type

Technical specifications and diagrams are measured with mineral oil ISO VG32 at 50°C (122°F) temperature.

	VUS/INC 14	VUS/INC 38	VUS/INC 12	VUS/INC 34
Nominal flow	18 l/min (4.8 US gpm)	25 l/min (6.6 US gpm)	50 l/min (13.2 US gpm)	78 l/min (20.6 US gpm)
Max. pressure	350 bar (5100 psi)			
Oil leakage	0.25 cm ³ /min (0.015 in ³ /min) at 210 bar (3050 psi)			
Fluid	mineral based oil			
Viscosity	from 10 to 200 cSt			
Max. level of contamination	18/16/13 ISO4406			
Fluid temperature	with NBR seals: from -20°C (-4°F) to 80°C (176°F)			
Environmental temp. for working conditions	-40°C (-40°F) to 100°C (212°F)			
Weight	Steel 0.01 kg (0.02 lb)	0.02 kg (0.04 lb)	0.04 kg (0.09 lb)	0.07 kg (0.15 lb)

NOTE - For different conditions, please contact Walvoil Sales Dpt.



Dimensions

Dimensions are in mm-in

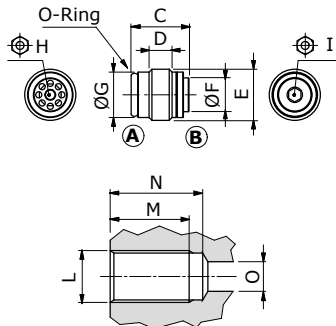

Valve type	ØC	D	E	G	ØG	⊕H	⊕I	O-Ring
VUS/INC14	17-0.67	6-0.24	G 1/4	9.2-0.36	11.3-0.445	3	3	1x9
VUS/INC38	18.5-0.73	7.5-0.29	G 3/8	11-0.43	14.8-0.57	3	4	1.78x10.82
VUS/INC12	23-0.90	9.5-0.37	G 1/2	14-0.55	18.5-0.73	5	6	1.78x14
VUS/INC34	28.5-1.12	14.5-0.57	G 3/4	19-0.75	24-0.94	8	8	2.62x18.72

Valve cavity for	L	M	N	O
VUS/INC14	G 1/4	25-0.98	28-1.1	8-0.31
VUS/INC38	G 3/8	27-.06	30-1.18	9-0.35
VUS/INC12	G 1/2	32-1.26	36-1.42	12-0.47
VUS/INC34	G 3/4	37-1.46	42-1.65	17-0.67

Ordering codes and description composition

VUS/INC **14/Pa0,5**
 Port size
 Opening pressure (bar)

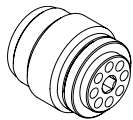

VUS/INC complete valves

TYPE	CODE	DESCRIPTION
VUS/INC 14/Pa0,5	1312110100	Opening pressure 0.5 bar (7.25 psi), G1/4 thread
VUS/INC 38/Pa0,5	1312120100	Opening pressure 0.5 bar (7.25 psi), G3/8 thread
VUS/INC 12/Pa0,5	1312130100	Opening pressure 0.5 bar (7.25 psi), G1/2 thread
VUS/INC 34/Pa0,5	1312140100	Opening pressure 0.5 bar (7.25 psi), G3/4 thread

For different configurations and SAE thread please contact our Sales Dpt.

Rating diagrams

VUS/INC14-38 pressure drop vs. flow
 opening pressure 0.5 bar (725 psi)

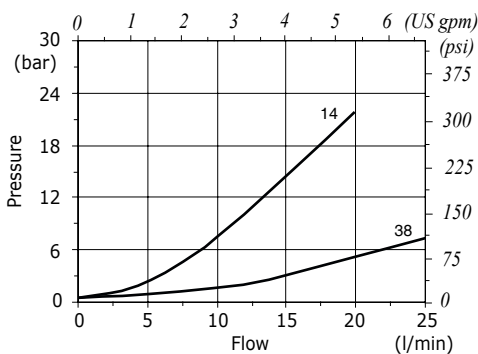

VUS/INC12-34 pressure drop vs. flow
 opening pressure 0.5 bar (725 psi)

